

CONSTRUCTION DRAWING

Colour Schedule

External		
Cladding	-	Surfmist
Roof	-	Zincalume
Capping	-	Surfmist
Doors	-	White
Windows	-	White

Internal		
Vinyl	-	Grey
Walls	-	Grey
Ceiling	-	White
Cabinetry	-	White

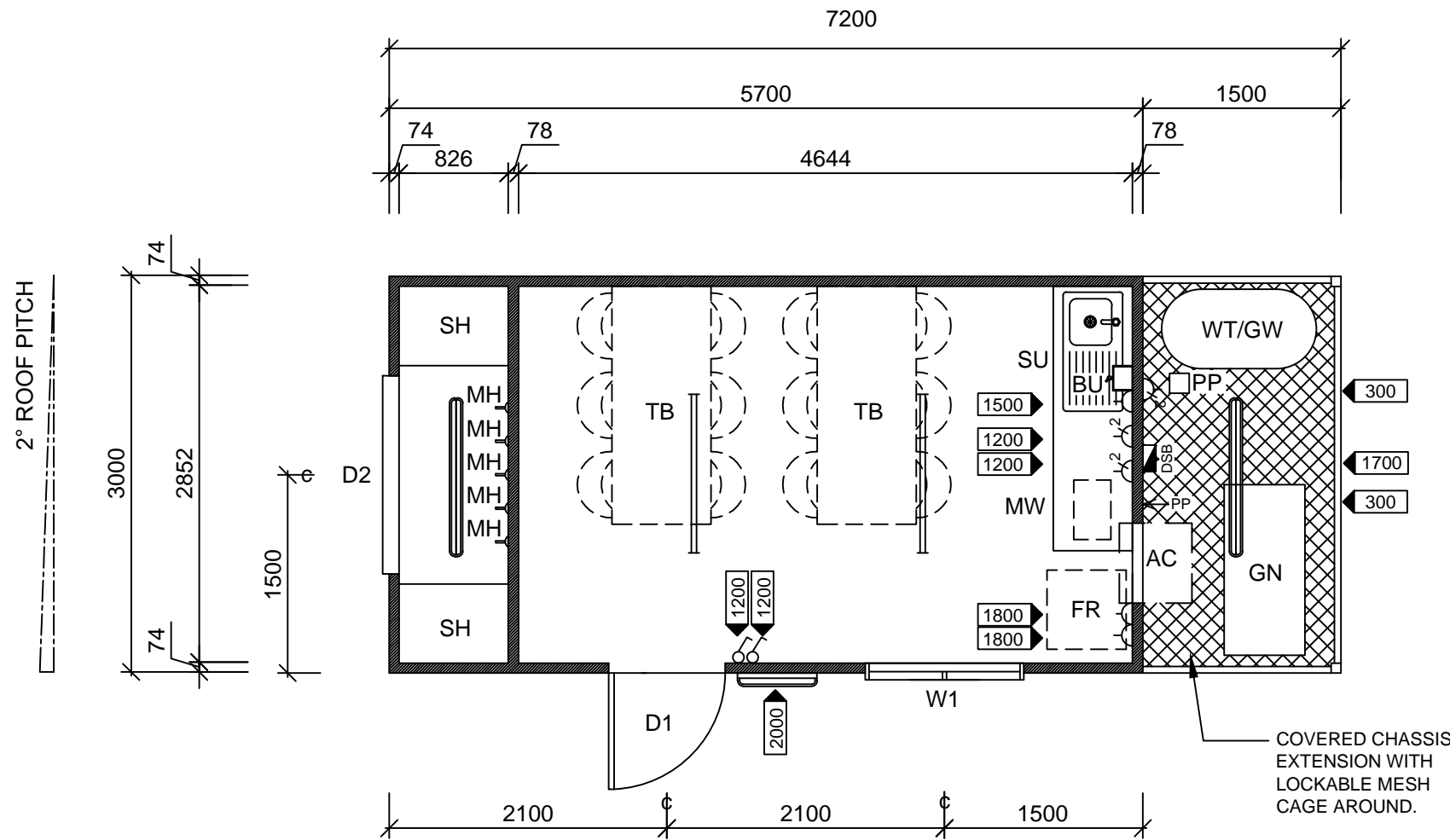

7.2x3.0m Site Crib Room - Floor Plan

Scale 1:50

PROJECT NUMBER:	PJF-336
SERIAL NUMBER:	SN.0664

CLIENT APPROVAL

Signature: _____ Date: _____

Rev.	Description	Date	By
A	Issued For Construction	16/03/17	BW



THIS DRAWING AND DESIGN IS THE SOLE PROPERTY OF JABEGIL PTY LTD T/A MULTITRADE BUILDING HIRE A.B.N. 36 010 138 600 IT MAY NOT BE REPRODUCED, COPIED WHOLE OR IN PART WITHOUT WRITTEN AUTHORITY.

CLIENT	DATE
	16/03/17
TITLE	SCALE
7.2x3.0m SITE CRIB ROOM	1:50
DESIGN WIND LOAD	DRAWN
C2 - CYCLONIC	BW
CHECKED	
DRAWING NUMBER	REVISION
SQF-3021-01	1
SHEET SIZE	
A3	

Item List

Item	Qty	Description
D1	x(1)	2040x920mm External Metal Clad Door With Passage Set, Hasp & Staple & Door Closer.
D2	x(1)	Roller Door (Approx. 2100mm High x 1500mm Wide)
W1	x(1)	1200x1200mm Sliding Glass Window - Grey Glass, With Full Cover Security Screen and Internal Roller Blind.
AC	x(1)	2.6kw Wall Mounted Reverse Cycle Air Conditioner.
GN	x(1)	6 kVa Kubota Lowboy Series 2 Mine Spec Single Phase Diesel Generator, Mounted On Covered Chassis Extension.
WT	x(1)	450 Ltr Potable Water Tank, On Metal Frame Over 'GW'.
GW	x(1)	450 Ltr Grey Water Waste Tank.
PP	x(1)	Water Pressure Pump.
SU	x(1)	2000mm Bench Top & Splashback, Cupboards Under, Single Bowl Single Drainer Sink (Cold Only).
BU	x(1)	Boiling Water Unit - Wall Mounted.
FR	x(1)	240 Ltr Fridge.
MW	x(1)	Microwave On Shelf.
TB	x(2)	Table With (6)x Chairs.
SH	x(2)	3 Tier Shelving - 500mm Deep.
MH	x(5)	Multipurpose Hook Fixed To Plywood Wall Sheets.

Notes

- Timber Frame Construction.
- 2400mm Internal Ceiling Height
- Vinyl Flooring Covered 150mm Up Walls In Crib Room & Store Room.
- 18mm CFC Flooring In Store Room Area.
- 19mm F11 T&G Flooring In Crib Room Area.
- Steel Mesh Flooring To External Services Area.
- Horizontal 'Panelrib' Profile External Colorbond Cladding.
- Zincalume 'Trimdek' Profile Roof Sheeting.
- Pre-finished Plywood Internal Wall & Ceiling Lining With PVC Joiners, Cornice & Corners In Crib Room Area.
- T&G Plywood Wall Sheeting To Store Room Area.
- Wall & Ceiling Insulation.
- Colorbond 'Panelrib' Soffit To External Service Area Ceiling.
- Steel Mesh Cage Around External Services Area.

Electrical Legend

Icon	Qty	Description
	x(1)	Metal External Lockable Distribution Switchboard With Double Pole Main Switch, Double Pole Circuit Breakers Fitted With Cirlock Metal Lockouts.
	x(1)	Plug In Electrical Point Of Entry.
	x(2)	Light Switch (Double Pole).
	x(3)	10amp Single GPO (Double Pole).
	x(2)	10amp Double GPO (Double Pole).
	x(1)	Weatherproof 10amp Double GPO (Double Pole).
	x(2)	36 Watt Double Fluorescent Light With Diffuser Clips
	x(1)	18 Watt Single External Fluorescent Light.
	x(2)	36 Watt Single External Fluorescent Light.

= Height Of Electrical Point