

PRELIMINARY DRAWING

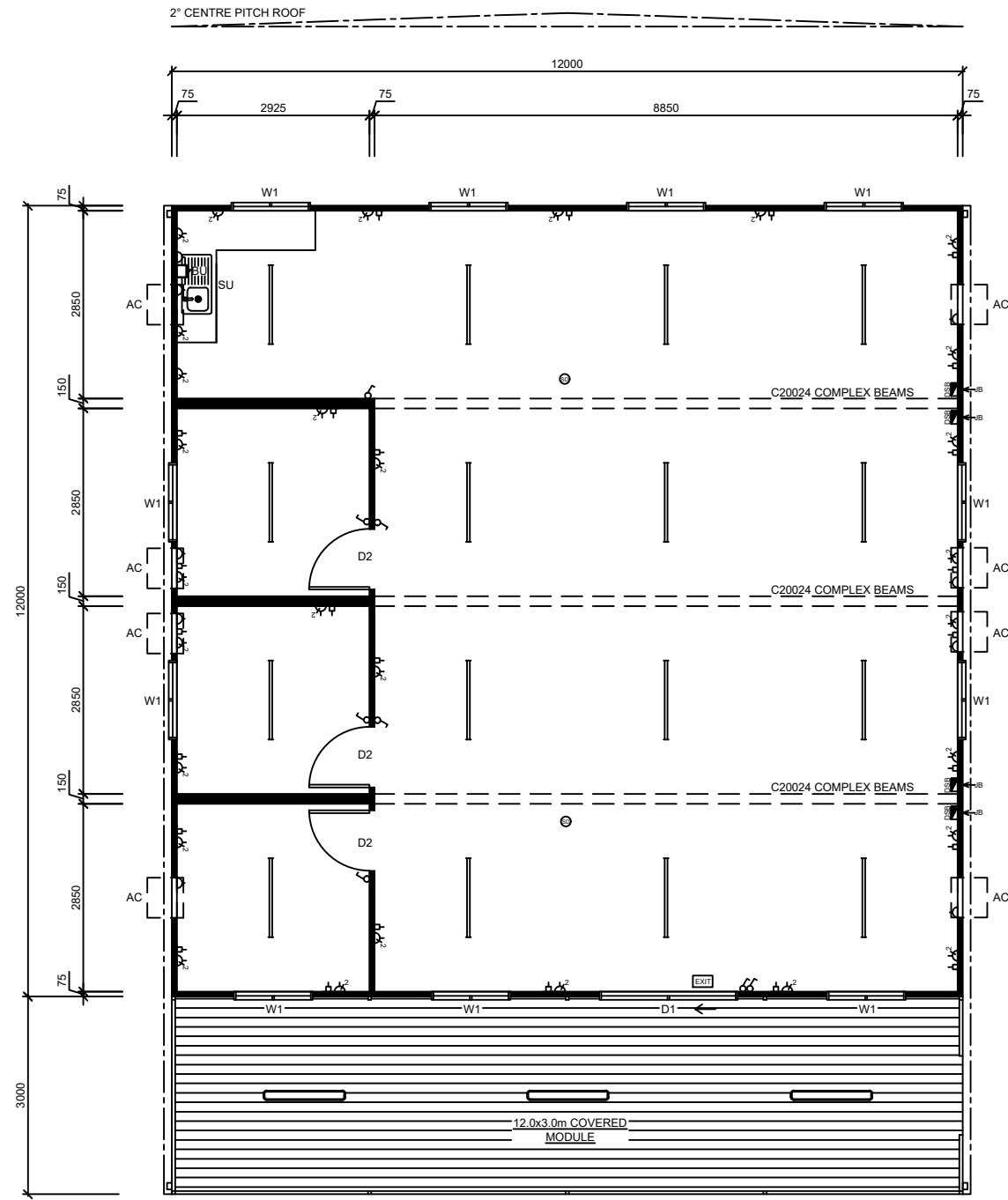

12.0x12.0m Complex & 12.0x3.0m Covered Deck - Floor Plan

Scale 1:100

Colour Schedule

External		
Cladding	-	Surfmist
Roof	-	Zincalume
Capping	-	Surfmist
Gutter	-	Surfmist
Downpipe	-	Surfmist
Doors	-	White
Windows	-	White

Internal		
Vinyl	-	Grey
Walls	-	Grey
Ceiling	-	White
Doors	-	Grey
Beams	-	Grey
Cabinetry	-	White

CLIENT APPROVAL

Signature: _____ Date: _____

Rev.	Description	Date	By
A	Issued for Client Review	07/06/18	BW



THIS DRAWING AND DESIGN IS THE SOLE PROPERTY OF JABEGIL PTY LTD T/A MULTITRADE BUILDING HIRE A.B.N. 36 010 138 600 IT MAY NOT BE REPRODUCED, COPIED WHOLE OR IN PART WITHOUT WRITTEN AUTHORITY.

CLIENT	DATE
ORICA - YARWUN	07/06/18

TITLE	SCALE
12.0x12.0m COMPLEX & 12.0x3.0m COVERED DECK	1:100

DESIGN WIND LOAD	DRAWN	CHECKED
C2 (W50C)	BW	

DRAWING NUMBER	REVISION	SHEET SIZE
SQF-3266-01	A	A3

Item List

Item	Qty	Description
D1	x(1)	2100x2100mm Sliding Glass Door - Grey Glass, Flydoor.
D2	x(3)	2040x920mm Internal Painted Hollow Core Door.
W1	x(12)	900x1200mm Sliding Glass Window - Grey Glass, Flyscreen.
AC	x(11)	Provision For Wall Mounted Air Conditioner Unit.
SU	x(1)	3500mm Laminated Bench Top & Splashback, Set Of Drawers & Cupboards Under, Single Bowl Single Drainer Sink (Cold).
BU	x(1)	Boiling Water Unit - Wall Mounted.

Notes

- Built To Multitrade Building Hire Specifications.
- 150x75mm PFC Chassis Bearers With C10015 Floor Joists @ 600mm Ctrs.
- 19mm T&G F11 Plywood Flooring.
- 2mm Commercial Vinyl Floor Covering.
- 2400mm Internal Ceiling Height.
- Horizontal 'Panelrib' Profile External Colorbond Cladding.
- Zincalume 'Trimdek' Profile Roof Sheeting.
- Pre-finished Plywood Internal Wall & Ceiling Lining With PVC Joiners, Cornice, Skirting & Corner Moulds.
- Wall & Ceiling Insulation.
- Gutter & Downpipes.

Electrical Legend

Icon	Qty	Description
	x(4)	Internal Distribution Switchboard
	x(4)	Junction Box - Electrical Point Of Entry
	x(8)	Light Switch
	x(9)	10amp Single GPO
	x(28)	10amp Double GPO
	x(24)	Draw Wire With Blank Plate
	x(16)	1200mm LED Batten Light Fitting
	x(3)	1200mm LED External Light Fitting
	x(2)	240 Volt Smoke Detector
	x(1)	Emergency Exit Light